

OPERATING INSTRUCTION

TS 200 – TS 300



General features

- Power supply.....230 Volts mono phased + ground rod
- Power350 watt
- Fuse.....2 Amp 5 x 20
- Sealing capacity310 x 250 mm
- Dimensions360 x 400 x 185 mm
- Weight..... Net = 8 kilos

Start up

- Connection to a 230 Volt mono socket (16 Amp)
- Press the switch, this one lights up.
- Heating time: about 15 minutes

Test

- Fold the paper on itself and place it on the tray
- Lower the welding arm and hold it on the paper for a few seconds
- Raise the arm and check the weld
- A uniform indentation on the paper is the guarantee of a perfect weld

Maintenance

- Daily cleaning is necessary
- Clean with a slightly damp cloth
- Do not use abrasives to clean the teflon coating

In case of failure

- Check that the switch is live
- Check the condition of the fuse and if necessary, replace it
- Contact the after sales service of your supplier

Spare parts list

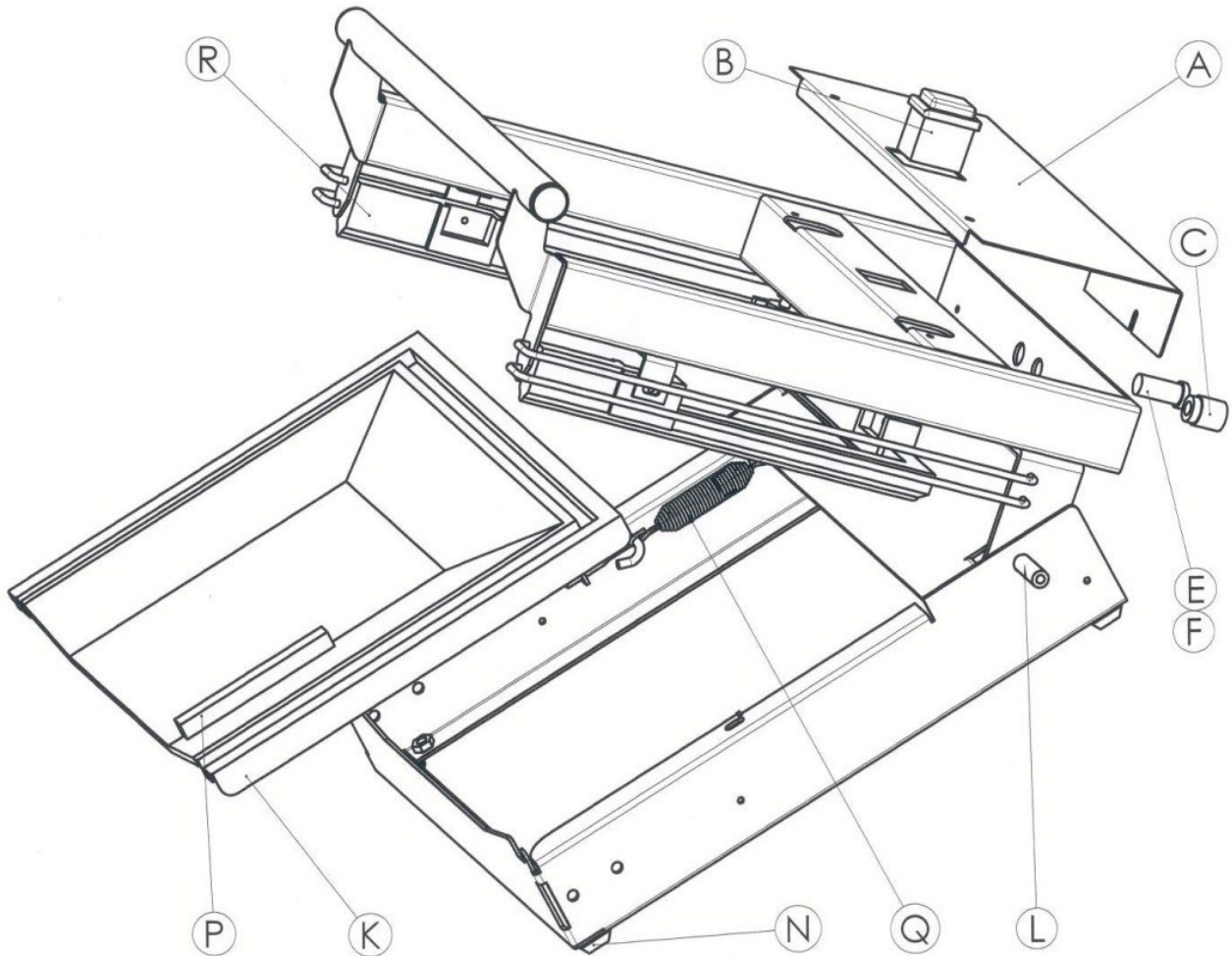

REP	Code	Désignation	Qté
A	TO-1229	Electrical cover	1
B	EL-1512	2-way switch 22 x 30	1
C	EL-1772	Power cord, moulded plug – lg 2.5 m – 3 x 0.75	1
E	EL-1404	Temporized fuse 5 x 20, 2 amp (x 10)	1
F	EL-1403	Fuse holder 5 x 20	1
K	TO-1272	Stainless steel plate	1
L	MG-0019	Pivot bolt	1
N	FI-1306	Adhesive leg	4
P	FI-1862	Silicon profile	1m
Q	FI-0136	Tension spring	1
R	EL-1861	Moulded resistance	1

Electrical diagram

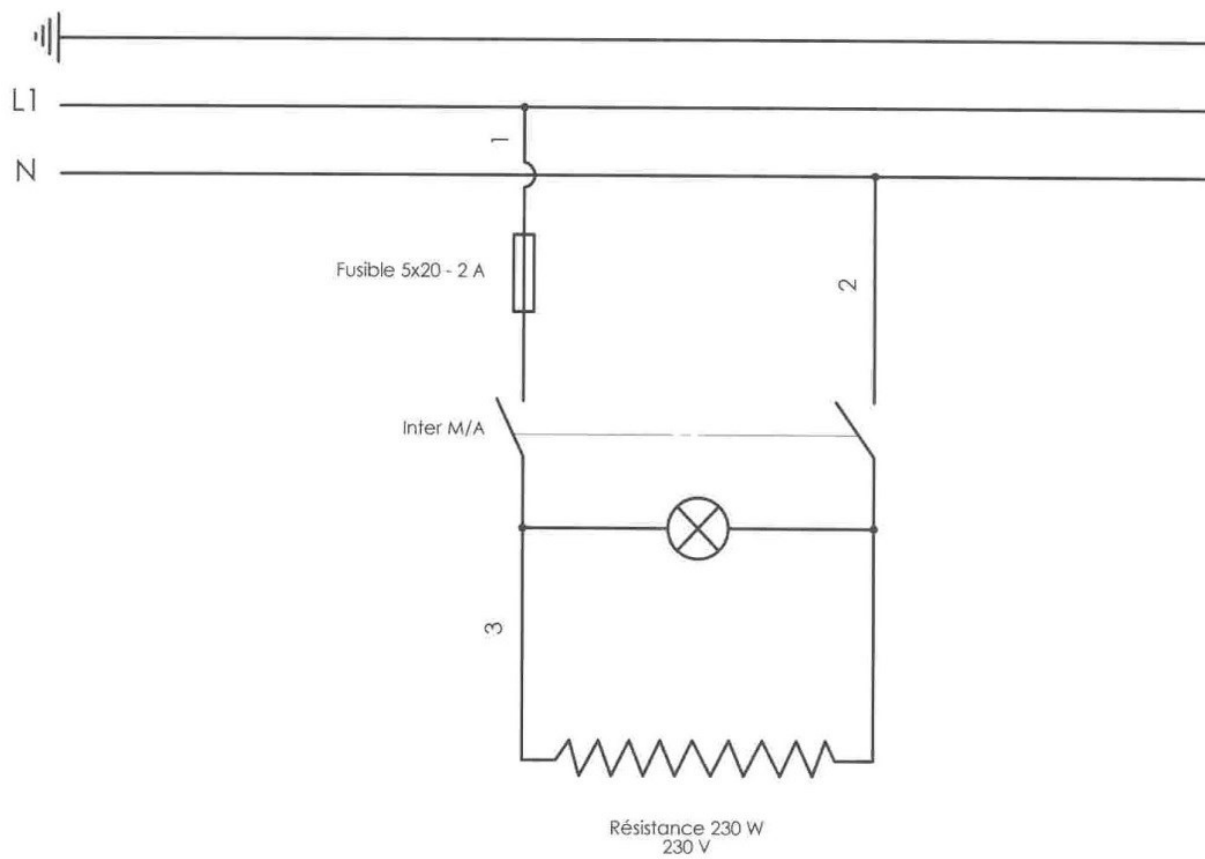

ATTENTION



**RISK OF BURNS WITH THE HEATING PLATE
THAT HEATED PERMANENTLY**